

SCRIBBLR WALLPAPER

Wallcoverings » Writable and Magnetic Wallcoverings

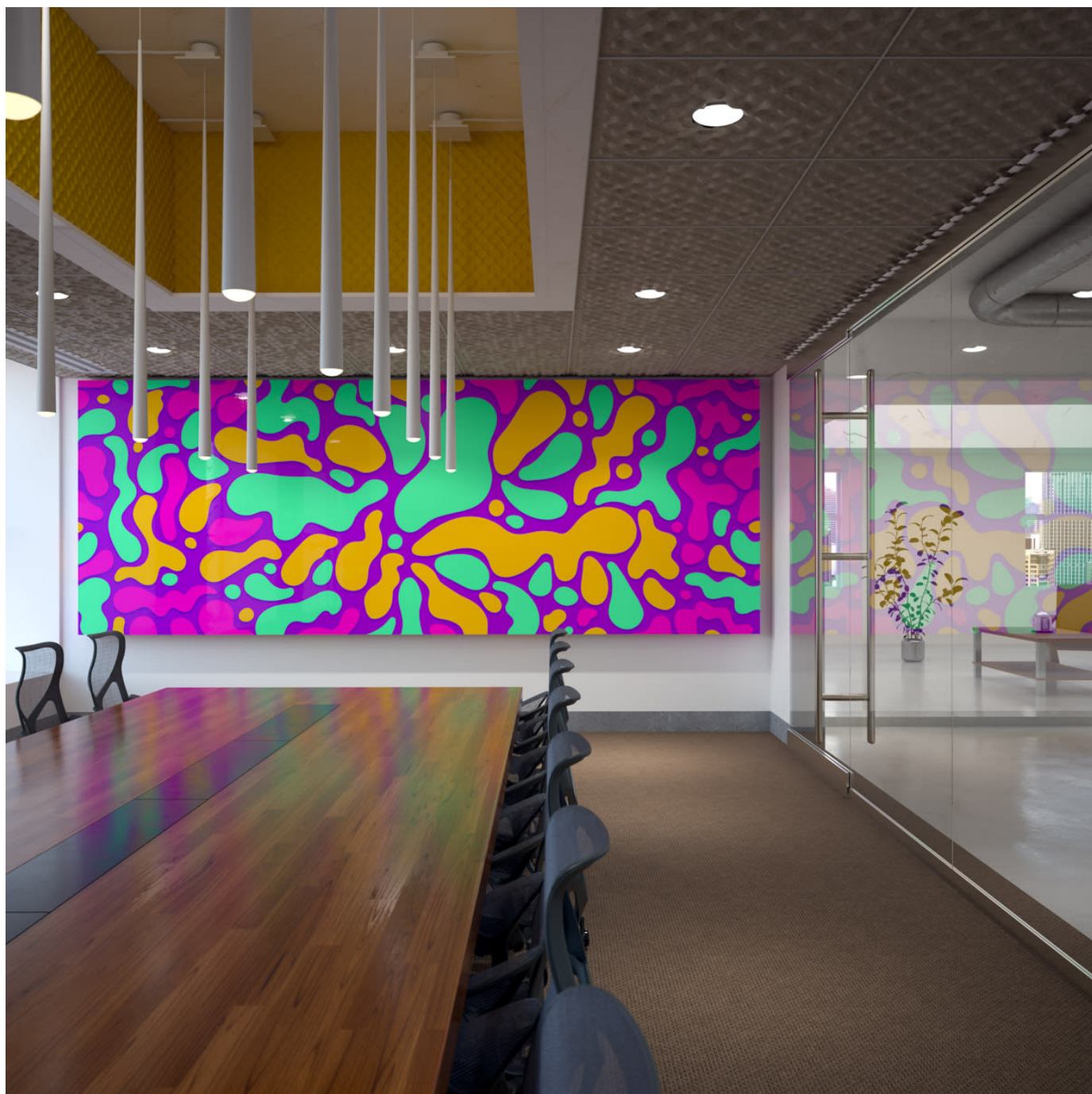

Brand: **Scribblr**

1300 306 399

info@baresque.com.au

baresque.com.au

1 of 4

SCRIBBLR WALLPAPER

Wallcoverings » Writable and Magnetic Wallcoverings



SCRIBBLR
WALLPAPER

SCRIBBLR WALLPAPER

Wallcoverings » Writable and Magnetic Wallcoverings



The option to design any space using custom wallcoverings with an added layer of magnet-receiving ferrous surfaces makes Scribblr Wallpapr amazing.

Description

Printable wallpaper meets opposites attract technology in this customizable, ferrous layered solution.

The option to design any space using custom wallcoverings with an added layer of magnet-receiving ferrous surfaces is what makes Scribblr Wallpapr amazing.

For all your creative needs, simplicity takes on a new level of cool that will turn all your friends green with envy.

Roll Size

150cm wide x 20m - Available by the lineal metre

Composition

Ferrous layer (magnet attracting) Printable (by us or you). Supplied unprinted unless noted.

Pattern Repeat Size

N/A

SCRIBBLR WALLPAPER

Wallcoverings » Writable and Magnetic Wallcoverings

Fire Rating

Tested in accordance with AS ISO 9705 2003 for the purpose of determining the Group Number classification as required by the Building Code of Australia for the control of fire spread on interior wall and ceiling linings.

The result achieved was:
Classification - Group 2
Specific Extinction - Less than 250m²/kg

Warranty

2-year warranty. Visit baresque.com.au/warranty for complete details.

Lead Time

- Held in stock in Australia. From receipt of full payment:
 - Sydney, Melbourne, Brisbane: 3 working days
 - Adelaide: 4 working days
 - Perth: 5-working days
-

Care Instructions

Remove dry erase markings with a microfiber cloth.

Press firmly in a circular motion when erasing.

Wash cloth or change erasers as they become dirty as dirty dry erase cleaning cloths and erasers will spread ink residue on the surface.

For daily cleaning, or as required, rinse the surface with water.

Dry the surface with a soft cloth prior to writing.

Always test in an inconspicuous area first.

If care instructions don't deliver the expected results, cease cleaning method immediately and contact Baresque for assistance.
